

Installation Instructions

安裝說明書

REAR TRAILING ARM

後側拖曳臂

#Q1054

Application 適用車型

TOYOTA GR YARIS GXPA16 '2020-

Components 內含配件

- ① Trailing arm-LH 控制臂-左側.....1pcs
- ② Trailing arm-RH 控制臂-右側.....1pcs
- ③ Stabilizer end link 防傾桿連接桿.....2pcs
- ④ Bolt-Hex 外六角螺絲 (M14x1.5x55).....2pcs
- ⑤ Nut-Flange self-lock 凸緣防鬆螺帽
(M12x1.25-19x13.5).....4pcs
- ⑥ Washer-anti slip 華司-齒面 (22x15x1.2t).....4pcs
- ⑦ Washer 華司 (21x12x3t).....2pcs

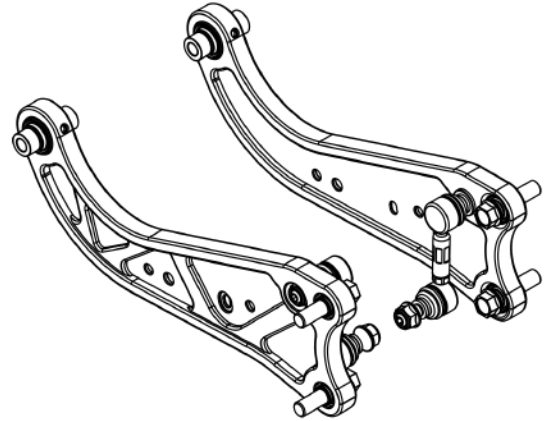

Caution 注意事項

- Installation is recommended to be performed by licensed mechanics with necessary tools to ensure safety. Incorrect installation may cause injury, damage to the product or vehicle. 安裝建議由合格的技師及工具執行以確保安全。安裝錯誤可能對人員、產品及車輛造成傷害。
- Note the routing of wires and cables before installation, or please refer to factory manual. 安裝前請事先記下線路的安裝路徑及位置以維持原廠配置。有疑問時請參考原廠手冊。
- Tighten bolts and nuts firmly by using handtools, and with specified torque if mentioned. 安裝過程請使用手動工具確實鎖緊螺帽及螺絲。如有特別註明請依照說明指示的扭力上鎖。

Instructions 安裝說明

1. Remove the factory trailing arms and stabilizer end links from the vehicle.
將原廠的拖曳臂以及防傾桿連接桿拆下車輛。
2. Install the adjustable end links to the new trailing arms using supplied M12 hardware first.
使用M12螺帽及華司，先將附件中的可調型連接桿，一端安裝至新的拖曳臂桿身。
3. Install the front end of trailing arms to chassis using the factory hardware.
使用原廠螺絲，將拖曳臂前端鎖至車身。
4. Install the rear end of trailing arms to rear knuckles using supplied M14 hardware.
使用M14螺絲及華司，將拖曳臂後端安裝至後羊角/轉向節。
5. Connect the stabilizer end links to the rear stabilizer bar.
將防傾桿連接桿的另一端連接至防傾桿。
6. Fit the hose and wire brackets to the trailing arms.
將管線支架固定於拖曳臂桿身。

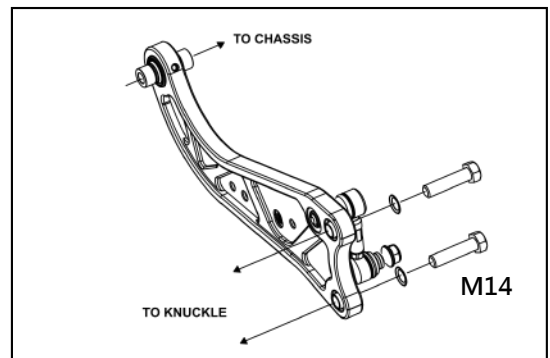
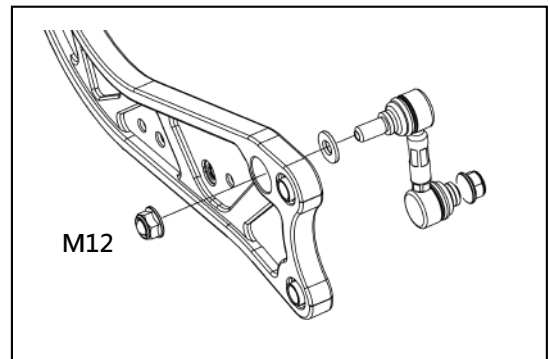

Illustration of installed state 安裝完成示意圖