

# Installation Instructions

## 安裝說明書

BRAKE MASTER CYLINDER STOPPER

煞車總泵頂桿

#Q1042

### Application 適用車型

TOYOTA GR86 ZN8 '22-  
SUBARU BRZ ZD8 '22-

### Components 內含配件

- ① Bracket 頂桿支架.....1pc
- ② Rubber stopper 橡膠墊塊.....1pc
- ③ Bolt - Hex socket 內六角螺絲 (M8x1.25x55)....1pc
- ④ Nut - Flange 凸緣螺帽 (M8x1.25-12x7.5).....1pc
- ⑤ Bolt - Flange 凸緣螺絲 (M6x1.0x16).....2pc

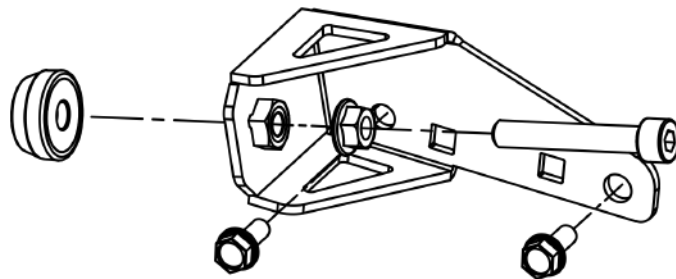

### Caution 注意事項

- Installation is recommended to be performed by licensed mechanics with necessary tools to ensure safety. Incorrect installation may cause injury, damage to the product or vehicle. 安裝建議由合格的技師及工具執行以確保安全。安裝錯誤可能對人員、產品及車輛造成傷害。
- Note the routing of wires and cables before installation, or please refer to factory manual. 安裝前請事先記下線路的安裝路徑及位置以維持原廠配置。有疑問時請參考原廠手冊。
- Tighten bolts and nuts firmly by using handtools, and with specified torque if mentioned. 安裝過程請使用手動工具確實鎖緊螺帽及螺絲。如有特別註明請依照說明指示的扭力上鎖。

### Instructions 安裝說明

1. Remove the plug near the brake master cylinder on the side of strut tower to access the M6 hole.  
將煞車總泵旁·左避震塔側面的蓋子移除·即可找到一M6螺孔。
2. Install the bracket onto the LH strut tower as shown in the pic using supplied M6 bolts.  
使用M6螺絲·將頂桿支架固定於避震塔上。
3. Install the supplied M8 hardware and stopper rubber. Then adjust the length until the rubber part contacts the master cylinder.  
安裝M8螺絲螺帽以及橡膠墊塊並調整長度·使橡皮部分支撐於煞車總泵。



Illustration of installed state 安裝完成示意圖