

Installation Instructions

安裝說明書

Rear Trailing Arm Bushing - Pillow Ball 後側拖曳臂鐵套-魚眼
#Q1585 (For Honda Civic FA/FD/FB/FG '06-12/'12-16)
Installation guide 安裝說明

Instructions 安裝說明

1.

Remove the trailing arms and press out the old bush.

Then press in the new pillow ball bush from the front side.

將拖曳臂卸下並退出舊的鐵套。將新鐵套從前端壓入拖曳臂。

2.

Reinstall the trailing arm to the vehicle. Please have the spacer facing up when attach the bush bar pin to the chassis.

將拖曳臂裝回車輛。鐵套中心桿(牛腿)上的墊高座請朝上向底盤安裝。

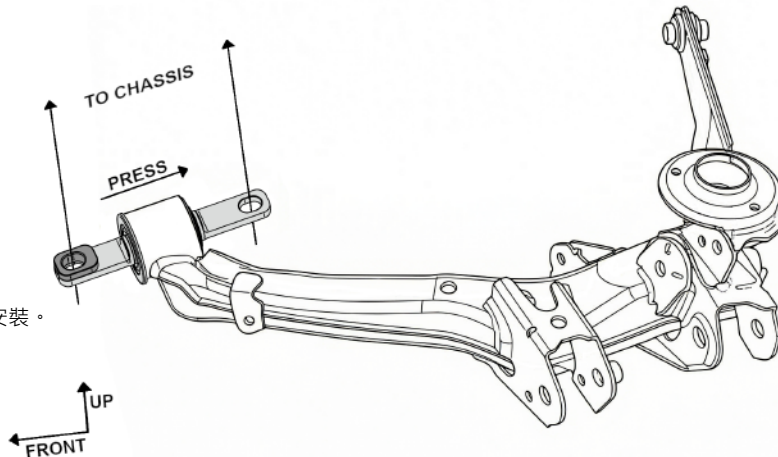

Caution 注意事項

- Installation is recommended to be performed by licensed mechanics with necessary tools to ensure safety. Incorrect installation may cause injury, damage to the product or vehicle.
安裝建議由合格的技師及工具執行以確保安全。安裝錯誤可能對人員、產品及車輛造成傷害。
- Note the routing of wires and cables before installation, or please refer to factory manual.
安裝前請事先記下線路的安裝路徑及位置以維持原廠配置。有疑問時請參考原廠手冊。
- Tighten bolts and nuts firmly by using handtools, and with specified torque if mentioned.
安裝過程請使用手動工具確實鎖緊螺帽及螺絲。如有特別註明請依照說明指示的扭力上鎖。