

# Installation Instructions

## 安裝說明書

FRONT UPPER CAMBER KIT

前上仰角調整器

#Q0664

### Application 適用車型

BMW 5-SERIES G30/G31  
BMW 6-SERIES GT G32

### Components 內含配件

- ① Control arm-L/R 控制臂-左/右.....1pcs
- ② Ride height sensor relocating bracket 車高感應器支架轉接座.....2pcs
- ③ Bolt 螺絲 (M6x1.0x16).....2pcs
- ④ Nut 螺帽 (M6x1.0-10x6).....2pcs

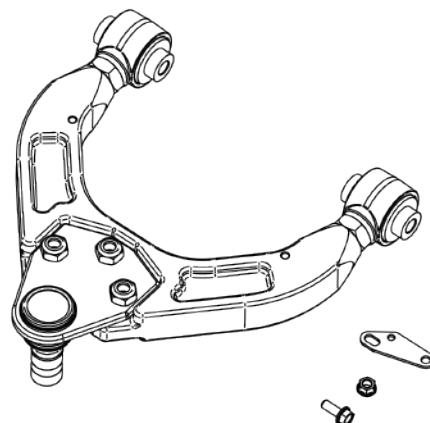

### Caution 注意事項

- Installation is recommended to be performed by licensed mechanics with necessary tools to ensure safety. Incorrect installation may cause injury, damage to the product or vehicle. 安裝建議由合格的技師及工具執行以確保安全。安裝錯誤可能對人員、產品及車輛造成傷害。
- Note the routing of wires and cables before installation, or please refer to factory manual. 安裝前請事先記下線路的安裝路徑及位置以維持原廠配置。有疑問時請參考原廠手冊。
- Tighten bolts and nuts firmly by using handtools, and with specified torque if mentioned. 安裝過程請使用手動工具確實鎖緊螺帽及螺絲。如有特別註明請依照說明指示的扭力上鎖。

### Instructions 安裝說明

1. Raise and safely support the vehicle.  
將車輛升起。
2. Remove OE upper arms and ride height sensor brackets.  
將原廠前上控制臂及車高感應器支架卸下。
3. Install ride height sensor relocating bracket to the new upper arms using supplied bolts.  
使用附件螺絲，將車高感應器支架轉接座安裝至新的前上控制臂。
4. Install the original ride height sensor brackets to the new relocation brackets using supplied nuts.  
使用附件螺帽，將原本的车高感應器支架安裝至新的轉接座上。
5. Install the new upper arms to vehicle. Then reconnect the ride height sensor linkage.  
將新的前上控制臂安裝至車輛，完成後將車高感應器連桿重新接上。
6. Adjust to desired camber settings. This should be done by professional to ensure the vehicle is properly aligned.  
完成後請接受定位校正，將負外傾角(Camber)調整至理想設定值。

