

Installation Instructions

安裝說明書

BRAKE MASTER CYLINDER STOPPER

煞車總泵頂桿

#Q0651

Application 適用車型

SUPRA J29 '19-

Components 內含配件

- ① Bracket-A 支架-A.....1pcs
- ② Bracket-B 支架-B.....1pcs
- ③ Rubber stopper 頂桿橡皮.....1pcs
- ④ Nut 螺帽 (M10x1.25-14x9.5).....1pcs
- ⑤ Bolt 螺絲(M6x1.0x15).....2pcs

Caution 注意事項

- Installation is recommended to be performed by licensed mechanics with necessary tools to ensure safety. Incorrect installation may cause injury, damage to the product or vehicle. 安裝建議由合格的技師及工具執行以確保安全。安裝錯誤可能對人員、產品及車輛造成傷害。
- Note the routing of wires and cables before installation, or please refer to factory manual. 安裝前請事先記下線路的安裝路徑及位置以維持原廠配置。有疑問時請參考原廠手冊。
- Tighten bolts and nuts firmly by using handtools, and with specified torque if mentioned. 安裝過程請使用手動工具確實鎖緊螺帽及螺絲。如有特別註明請依照說明指示的扭力上鎖。

Instructions 安裝說明

1. Remove the driver side part of cowl panel to access brake master cylinder.
將駕駛座側的塑膠蓋板卸下後即可找到煞車總泵及油壺。
2. Remove the two bolts from the bracket on top of strut tower.
將避震器塔頂上方固定支架的兩顆螺絲卸下。
3. Install the two brake master cylinder stopper brackets using supplied M6 bolts.
使用附件中的M6螺絲組裝煞車頂桿支架。
4. Install the rubber stopper using supplied M10 nut.
使用附件的M10螺帽安裝頂桿橡皮。
5. Install the assembled brake master cylinder stopper. The stopper bracket should be installed between strut tower and the top bracket.
將組裝完成的煞車總泵頂桿安裝至車輛。
6. Reinstall the two bolts of driver side strut tower top bracket.
將駕駛座側的避震塔固定支架螺絲裝回。
7. Adjust the length of stopper until the rubber reaches the cylinder.
調整頂桿之長度，使頭端橡皮部分頂住煞車總泵。
8. Reinstall the driver side cowl panel.
將駕駛座側的塑膠蓋板裝回。

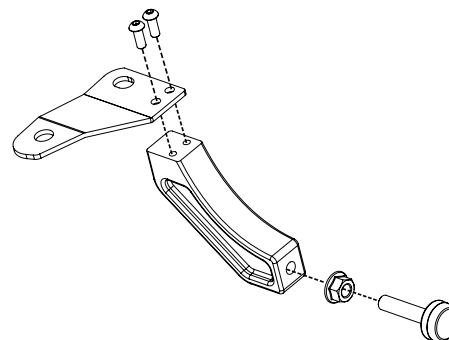
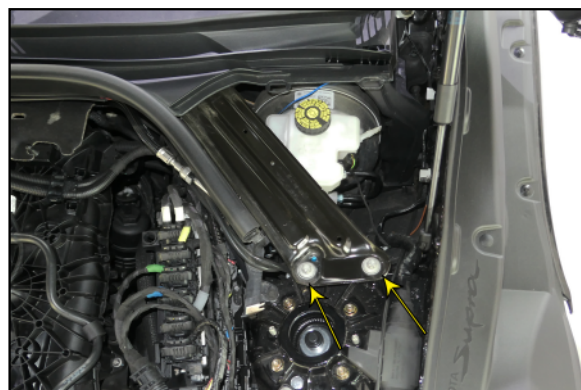
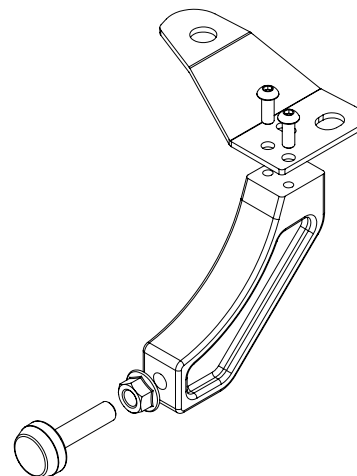

Illustration of installed state 安裝完成示意圖