

Installation Instructions

安裝說明書

REAR ADD-ON SWAY BAR
後加裝型防傾桿, 17mm
#Q0557

Application 適用車型

LUXGEN S5 '11-
LUXGEN U6 '13-

Components 內含配件

- ① Sway bar 防傾桿桿身.....1pcs
- ② Bracket-RH 支架-右.....1pcs
- ③ Bracket-LH 支架-左.....1pcs
- ④ Bolt 螺絲 (M10x1.25x35).....2pcs
- ⑤ Bolt 螺絲 (M10x1.25x25).....4pcs
- ⑥ Nut 螺帽 (M10x1.25-14x9).....6pcs
- ⑦ Washer 華司 (20.8x10.7x2).....4pcs

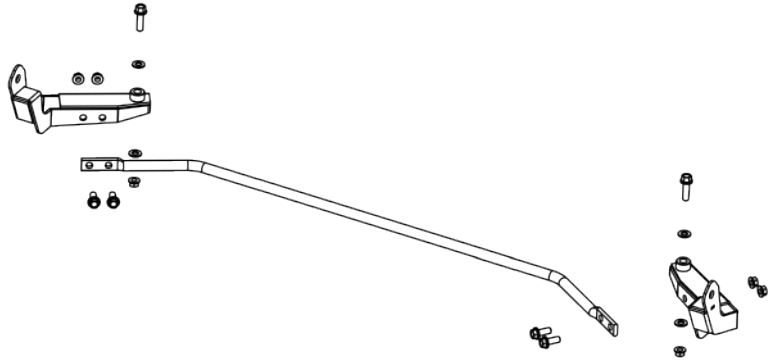

Caution 注意事項

- Installation is recommended to be performed by licensed mechanics with necessary tools to ensure safety. Incorrect installation may cause injury, damage to the product or vehicle. 安裝建議由合格的技師及工具執行以確保安全。安裝錯誤可能對人員、產品及車輛造成傷害。
- Note the routing of wires and cables before installation, or please refer to factory manual. 安裝前請事先記下線路的安裝路徑及位置以維持原廠配置。有疑問時請參考原廠手冊。
- Tighten bolts and nuts firmly by using handtools, and with specified torque if mentioned. 安裝過程請使用手動工具確實鎖緊螺帽及螺絲。如有特別註明請依照說明指示的扭力上鎖。

Instructions 安裝說明

1. Remove rear shock absorber lower mounting bolts.
將後減震筒下端固定螺絲卸下。
2. Install the brackets to the lower spring seat using supplied M10x1.5 bolts(35mm), nuts and washers.
使用附件M10x1.25螺絲(35mm長)、螺帽及華司，將兩側支架安裝至彈簧下座。
3. Reinstall the rear shock absorber mounting bolts.
將後減震筒固定螺絲鎖回。
4. Install the sway bar to the brackets using supplied M10x1.25 bolts (25mm) and nuts.
使用附件M10x1.25螺絲(長25mm)及螺帽，將防傾桿安裝至兩側支架。

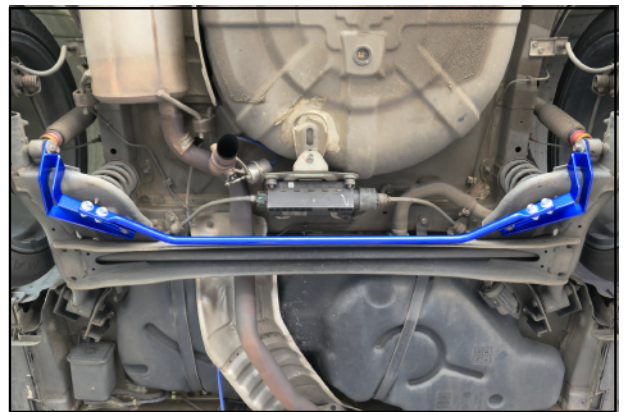
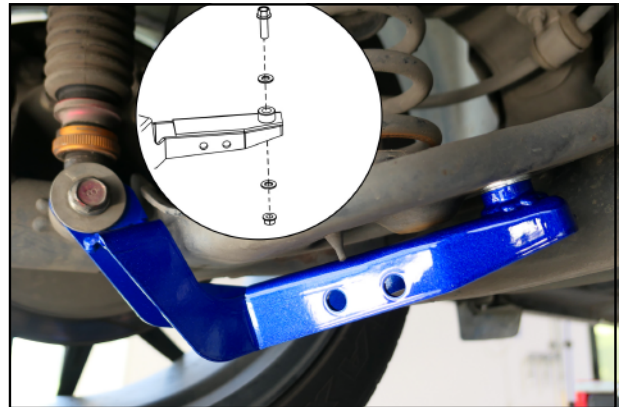
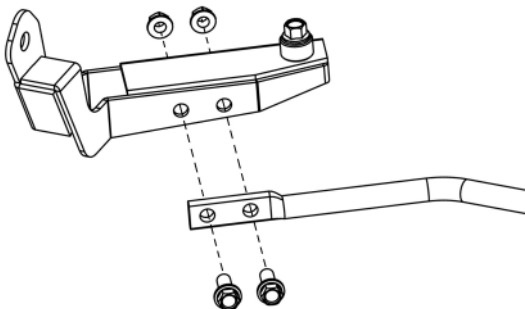

Illustration of installed state 安裝完成示意圖