

# Installation Instructions

## 安裝說明書

BRAKE MASTER CYLINDER STOPPER

剎車總泵頂

#Q0296

### Application 適用車型

Ford Mondeo '14-present MK5

### Components 內含配件

① Bracket 支架	1pcs
② Rubber 橡皮 (M10x1.5x75)	2pcs
③ Nut 螺帽 (M10x1.25-14x9.5)	2pcs

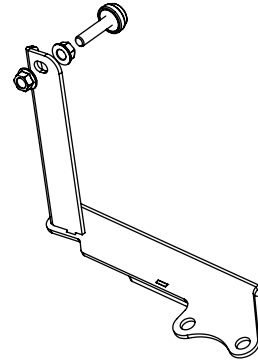

### Caution 注意事項

- Installation is recommended to be performed by licensed mechanics with necessary tools to ensure proper installation and safety, or damage to the product or vehicle may occur.
- Note the routing and position of wires and cables before installation. Please refer to factory manual.
- Tighten bolts and nuts firmly using handtools, or with specified torque if mentioned.
- 安裝需由合格的專業技師及工具執行以確保安裝正確及安全，否則可能對產品或車輛造成傷害。
- 安裝前請記下線路安裝路徑及位置，或請參考原廠手冊。
- 請使用手動工具確實鎖緊螺帽及螺絲，或依照說明中標註的扭力上鎖。

### Instructions 安裝說明

1. Disconnect battery cables, then remove battery, air filter box and battery tray to access brake master cylinder.  
斷開電瓶後將電池、空氣濾清器及電瓶底板拆下即可找到剎車總泵。
2. Install supplied Stopper and Nuts to Bracket as shown in components figure.  
請參考配件圖，將助頂器橡皮及螺帽安裝於支架上。
3. Remove nuts from the studs (arrows) to install bracket then reinstall the factory nuts to secure the bracket.  
將螺絲(箭頭處)中的螺帽卸下後安裝支架，完成後將螺帽鎖回以固定支架。
4. Adjust the stopper nuts until the stopper contacts the brake master cylinder.  
調整助頂器螺帽，使助頂器橡皮支撐於剎車總泵。
5. Cut the circled part of battery tray out, then reinstall the tray, air filter box and battery to the vehicle.  
將電瓶底板畫圈處切下，並將底板、空氣濾清器以及電瓶裝回車輛。

