

Installation Instructions

安裝說明書

RC TIE ROD END
強化魚眼拉桿和尚頭
#Q0288

Application 適用車型

Nissan 370Z / Farilady Z Z34 '09-present
Infiniti G / Nissan Skyline V36 '07-14

Components 內含配件

① Link & heim joint 桿身及魚眼球頭	2pcs
② Shank 球頭桿	2pcs
③ Castle nut 皇冠螺帽	2pcs
④ Flange nut 凸緣螺帽	2pcs
⑤ Spacer 墊片 (5mm)	2pcs
⑥ Spacer 墊片 (10mm)	2pcs
⑦ Cotter pin 開口銷	4pcs

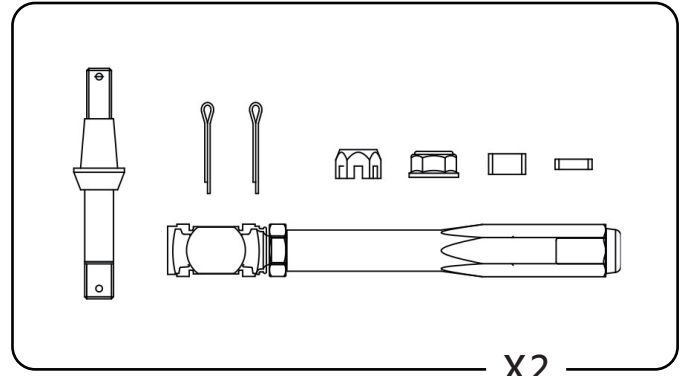

Caution 注意事項

- Installation is recommended to be performed by licensed mechanics with necessary tools to ensure proper installation and safety, or damage to the product or vehicle may occur.
- Note the routing and position of wires and cables before installation. Please refer to factory manual.
- Tighten bolts and nuts firmly using handtools, or with specified torque if mentioned.
- 安裝需由合格的專業技師及工具執行以確保安裝正確及安全。否則可能對產品或車輛造成傷害。
- 安裝前請記下線路安裝路徑及位置，或請參考原廠手冊。
- 請使用手動工具確實鎖緊螺帽及螺絲，或依照說明中標註的扭力上鎖。

Instructions 安裝說明

1. Remove factory tie rod ends from inner tie rods and steering knuckles on both sides.
將原廠的方向機拉桿和尚頭從內側舵桿及轉向節上卸下
2. Position supplied shanks (tapered studs) into steering knuckles, then install supplied flange nuts to the upper portion of the shanks.
安裝球頭桿於轉向節，並使用附件凸緣螺帽將球頭桿頂端鎖上。
3. Install supplied links and joints to inner tie rods, then slide the joints up onto the bottom and install supplied spacers and castle nuts to secure the joints.
將桿身安裝至方向機內側舵桿，再將桿身球頭端置入球頭桿底部，並使用配件墊片及螺帽從底部鎖上。
4. Install supplied cotter pins to the both ends of the shanks.
安裝配件開口銷至球頭桿的兩端。

Note 提示

- ※ The tie rod ends are designed to correct steering tie rod angle to eliminate bump steer of lowered vehicles.
此和尚頭能修正車高降低後車輛的方向機角度。
- ※ Installation positions of the 5mm & 10mm spacers are interchangeable to accommodate various ride height settings.
配件墊片厚度分為5mm及10mm，安裝位置可依照車高設定上下互換。

Please have the vehicle professionally aligned after installation.
請於安裝完成後接受電腦四輪定位校正

Illustration of installed state
安裝完成示意圖

